

Create pdf

Lampholders for discharge lamps

25.809.3800

G12

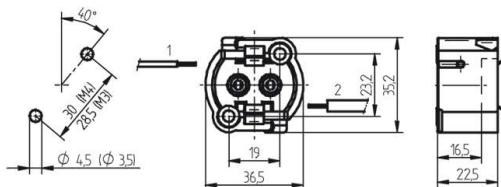

pkg.	wt.	part no.
216	38 g	25.809.3800.00

Connection: without cable, single pushwire terminals

For Metal Halide lamps

Screw fixing

Housing: Ceramic / PPS
 Contacts: CuSn, nickel-plated

- Maximum permissible diameter of the insulation for cable 1: 2.3 mm
- Maximum permissible diameter of the insulation for cable 2: 4.2 mm
- The requirements on light fittings of protection class II can be complied with through corresponding embodiment into metal components, without the use of additional insulating material
- Please consult us by fixing at rear with M3 rivet.

T 180			2 A 1000 V	
		0.5 - 1.0 mm ²		

Document generated on: Fr, 10. February 2017 - 13:28